



PROCEDURE:	OCCULT BLOOD FOR HEMOSURE® IFOB TEST
-------------------	---

The following collection procedure will allow you to collect and prepare an adequate specimen when an occult blood culture is required by your doctor. Please read carefully the following instructions and prepare the necessary material. Follow each step thoroughly.

Notes

- Acquire the specific collection kit from your doctor or the laboratory.
- A total of two separate stool specimens should be collected from consecutive bowel movements.
- Specimen conservation:
 - Store unopened kits at 4-30°C. The kit is stable until the date printed on the pouch label.
 - After sample collection, the fecal collection tube may be safely stored up to fourteen (14) days at ambient room temperature as high as 98.6°F (37 °C), up to six (6) months in refrigerator at 39.2°F (4°C)
- A specimen should not be collected from a patient with the following conditions that may interfere with the tests results:
 - Menstrual bleeding
 - Bleeding hemorrhoids
 - Constipation bleeding
 - Urinary bleeding

1) Diet and medication instructions

Diet

- No special diet is required. Eat as you would normally.
- No interference was observed with: aqueous extracts of broccoli, cantaloupe, cauliflower, horseradish, parsnip, raw turnip, and red radish.

This assay is not affected by dietary peroxidases, animal blood or asorbic acid.

Medication

Certain medications may cause gastrointestinal irritation resulting in occult bleeding. This may result in a false positive test result. Consult your physician.



You must consult with your physician prior to stopping any medication

2) Instructions for collecting and preparing the samples

The special collection kit includes: sample collection paper, sample collection tube, envelope.

You have to prepare the two samples collection from consecutive bowel movements following the same procedures.

Step 1- Sample deposit:

1. Fill out personal information on attached label on tubes.
2. Lift toilet seat and position sample collection paper across the rim of the toilet bowl. Secure adhesive tabs to the sides of toilet rim. Lower the toilet seat.

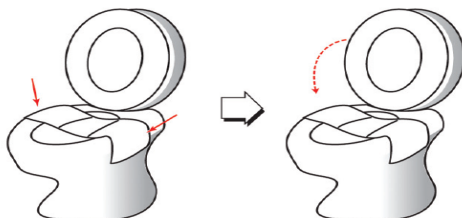

3. Make bowel movement onto collection paper.



Step 2 – Sample collection:

1. Unscrew the purple cap from the sample collection tube. DO NOT POUR OUT THE LIQUID.

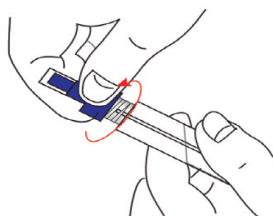



2. Poke spiral applicator into stool at **6** different sites. Use only enough fecal material to cover the tip of the applicator. **DO NOT CLUMP, SCOOP, OR FILL THE TUBE.** Placing too much stool in the sample collection tube will result in an unacceptable sample and you will be required to repeat the test.

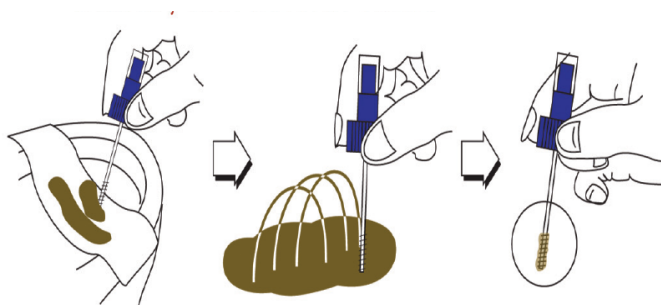

3. Screw the applicator back into the tube and secure tightly.

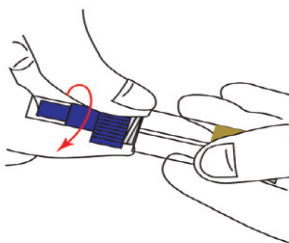

Step 3 – Sample return:

1. Fill out the return envelope with either your doctor or the laboratory's address.

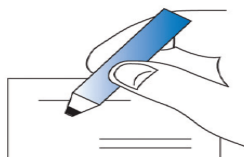

2. Insert sample collection tubes into specimen pouch and seal. Insert specimen pouch into return envelope and seal.



3. Return the sample packet immediately by mail or in person.

